

# SUB-MINIATURE LOAD CELL

**SPEC SHEET**  
**LCFD**

**\$750**

**Model LCFD-100 Shown**  
**LCFD Series**  
**Tension/Compression**

**± 50 grams to ± 1000 lb**  
**± 0.5 N to ± 5,000 N**

1 Newton = 0.2248 lb  
1 daNewton = 10 Newtons  
1 lb = 454 g  
1 t = 1000 kg = 2204 lb

**SPECIFICATIONS:**

**Excitation:** 5V ac/dc (1kg-10 lb)  
10V ac/dc (20-500 lb)

**Output:** 2 mV/V (>1kg)  
20 mV/V (<1kg)  
1.5 mV/V (1kg)

**Accuracy: (Linearity and Hysteresis combined):** ± 0.15% FSO (<250 lb)  
± 0.2% FSO (250 to 1000 lb)

**Repeatability:** ≥ 1kg: ±0.05% FSO  
<1kg: .1% FSO

**Zero Balance:** ±2% FSO

**Operating Temp Range:** -54° to 121°C  
(-65° to 250°F)

**Compensated Temp Range:**  
+16° to +71°C (+60° to 160°F)

**Thermal Effects:** Span: 0.015 % of FSO/°F (50g-500g); 0.005% of FSO/°F >500g  
Zero: 0.015% of FSO/°F (50g-500g); 0.005% of FSO/°F >500g

**Safe Overload:** 150% of Capacity

**Ultimate Overload:** 300% of Capacity

**Bridge Resistance:** 350 ohms nominal

**Construction:** Stainless Steel

**Electrical Connection:** 5 Ft. (1.5 m)  
4 Conductor, Shielded Teflon Cable

**For Sales and Service**  
**In U.S.A. and Canada**

**1-800-872-3963<sup>SM</sup>**  
**1-800-USA-DYNE**

**International Customers Dial**  
**(614) 965-9340**  
**24-Hour FAX (614) 965-9438**

**OMEGADYNE<sup>SM</sup> FAX**

OMEGADYNE's 24-Hour  
On-Line Publishing Service

**1-800-344-3963<sup>SM</sup>**  
**1-800-DIG-DYNE**

Document # 3612

**OMEGADYNE, Inc.**

149 Stelzer Court, Sunbury, OH 43074

<http://www.omegadyne.com>

e-mail: [info@omegadyne.com](mailto:info@omegadyne.com)



Formerly  
T-HYDRONICS, INC.

© COPYRIGHT 1996 OMEGADYNE, INC. ALL RIGHTS RESERVED.

Small in size and capable of providing highly accurate readings, the OMEGADYNE™ LCFD Series load cells are precision sub-miniature load cells for industrial applications requiring a small size and high accuracy. They are all stainless steel, measure both tension and compression loads and have male thread studs for load attachment. The exclusive internal design provide superior long term stability and minimizes the effects of small off axis loads.

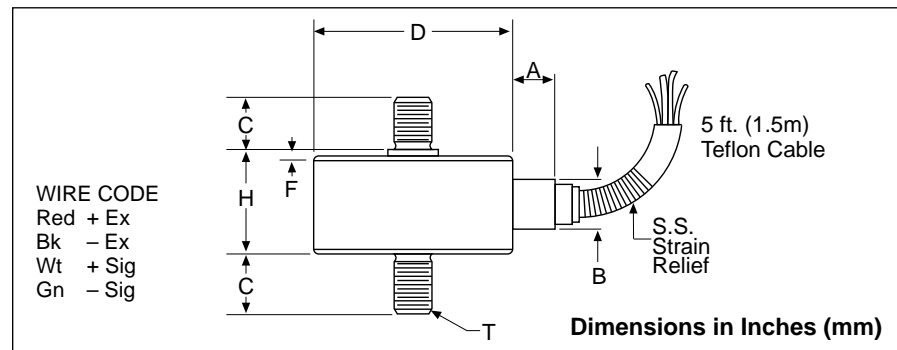

LOAD RANGE	T	F	D DIA.	H	A	B DIA.	C
50g to 500g	#6-32 UNC	0.05 (1.3)	1.00" (25.4)	0.75" (19)	0.50" (12.7)	0.38" (9.7)	0.25" (6.35)
1Kg to 10 lb	#6-32 UNC	0.05 (1.3)	0.75" (19)	.50" (12.7)	.31" (7.8)	.19" (4.8)	.25" (6.35)
25, 50, 100 lb	#10-32 UNF	0.12 (3.0)	1.00" (25.4)	.64" (16.3)	.5" (12.7)	.25" (6.35)	.25" (6.35)
250 to 1000 lb	¼-28 UNF	0.03 (0.76)	1.00" (25.4)	.55" (14)	.5" (12.7)	.25" (6.35)	.38" (9.7)

**► Most Popular Models Highlighted ◀ Prices Shown in U.S. Dollars**

To Order: (Specify Model Number)					
Capacity	Model No.	Price	Compatible Meters	Accessory Rod Ends	Price
± 50 g	LCFD-50G	\$1075	INFW,INFS, INFCS	REC-006F	\$10 ea.
± 100 g	LCFD-100G	1075	INFW,INFS, INFCS	REC-006F	10
± 250 g	LCFD-250G	1075	INFW,INFS, INFCS	REC-006F	10
± 500 g	LCFD-500G	1075	INFW,INFS, INFCS	REC-006F	10
± 1 kg	LCFD-1KG	750	INFW,INFS, INFCS	REC-006F	10
± 5 lb	LCFD-5	750	INFW,INFS, INFCS	REC-006F	10
± 10 lb	LCFD-10	750	INFW,INFS, INFCS	REC-006F	10
± 25 lb	LCFD-25	750	INFW,INFS, INFCS	REC-010F	10
± 50 lb	LCFD-50	750	INFW,INFS, INFCS	REC-010F	10
± 100 lb	LCFD-100	750	INFW,INFS, INFCS	REC-010F	10
± 250 lb	LCFD-250	750	INFW,INFS, INFCS	REC-014F	10
± 500 lb	LCFD-500	750	INFW,INFS, INFCS	REC-014F	10
± 1000 lb	LCFD-1K	750	INFW,INFS, INFCS	REC-014F	10

Metric Ranges Available—Consult Engineering.

**Ordering Examples:** 1.) LCFD-250G is a 250 gram load cell, \$1075, matching rod end REC-005F, \$10 ea. 2.) LCFD-500 is a 500 lb capacity load cell, \$750, matching rod end REC-014F, \$10 ea. 3.) LCFD-100 is a 100 lb capacity load cell, \$750, matching rod end REC-010F, \$10 ea.

Printed On Recycled Paper